

Archival boxes – KS 14

Folding instructions

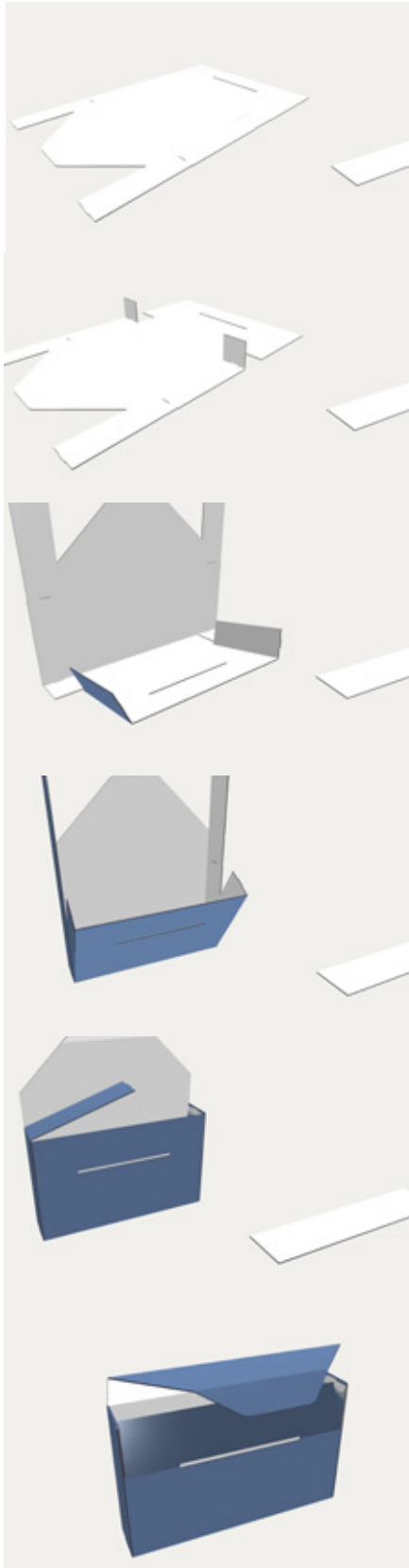

1. The precut pattern of your box cutting should be placed on the table with the natural white coloured side facing towards you.
2. Fold all the prefluted edges vertically at a 90 degree angle, once facing upwards and thereafter back again. Set up the side segments of your box right-angled
3. Bend the double-walled side segments inwards over the edges.
4. Now fold the side with the long slit and angled side segments over the shorter side flaps, so tha the side segmets are facing inwards. Afterwards fold the long side segments at a 180° angle inwards and fold them towards the interior of the box.
5. Insert the additional base reinforcement with the coloured (light grey) side, visible, into the box.
6. You may now close the box by inserting the lid-flap into the long slit provided.

We have manufactured your product with utmost care and accuracy.

Should you still have difficulties in folding your box, please do not hesitate to contact us. We will gladly assist you.

Please visit the following site for the animated version of the folding instructions:

[http: www.movies.klug-conservation.com](http://www.movies.klug-conservation.com)

KLUG-CONSERVATION

Zollstraße 2
87509 Immenstadt/Germany
Tel. +49 (0)8323 9653 30
www.klug-conservation.com

